

1735 PARK AVENUE  
2A  
2<sup>ND</sup> FL

SE CORNER OF 121<sup>ST</sup> ST & PARK AVE

HARLEM AREA -  
NEAR 125<sup>TH</sup> ST  
CORRIDOR

Professional Office Space  
/ Medical Space  
For Lease

GAVIOS

REALTY GROUP, LLC

# 1735 PARK AVENUE

- Approx 6,500 RSF
- Fully Built Out. Move In Condition
- Wrap around frontage (over 150 feet of natural light exposure)
- Large Freight elevator and modern passenger elevator
- High Ceiling heights throughout

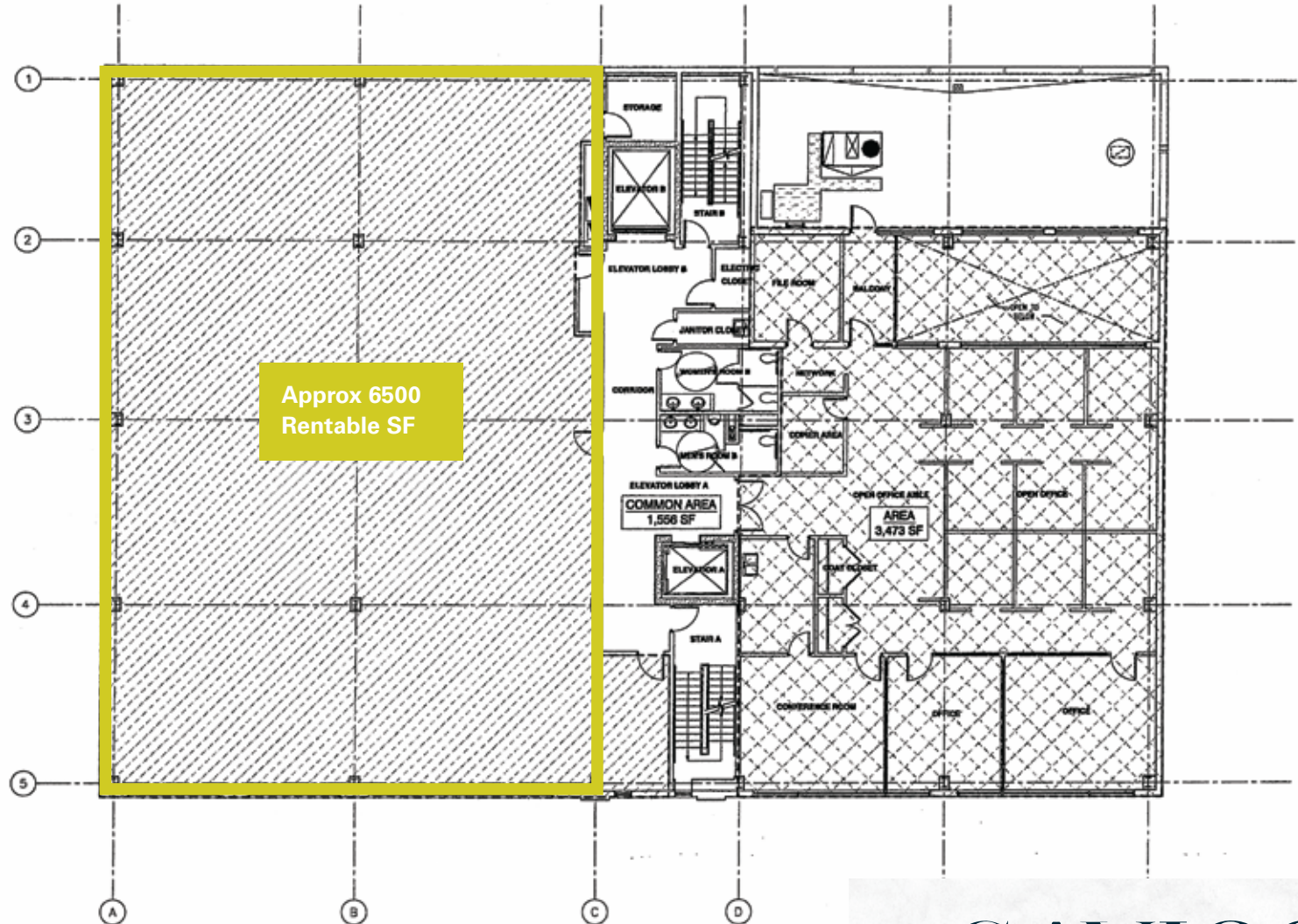

# GAVIOS

REALTY GROUP, LLC

# 1735 PARK AVENUE

**MTA** Metro-North Railroad

4 5 6

## NEIGHBORHOOD

- Across the street from Henry J Carter Hospital (previously North General Hospital)
- Across the street from Dr. Edmund M. Horan School
- 4 blocks to the Metro North Train Station on 125th Street
- Near 125th street shopping hub



## COMMENTS

- Immediate proximity to the Harlem 125th Street Station in excess of 9 million annual ridership
- Will divide
- Immediate possession

**AARON GAVIOS**  
Chairman & CEO  
aaron@gaviosrealty.com

14 Penn Plaza, Suite 1800  
New York, NY 10122  
Tel: 212. 971.0007  
www.gaviosrealty.com

Gavios Realty Group, LLC makes no warranty, expressed or implied, as to the accuracy or completeness of this communication and any attachment. This communication may contain errors and omissions. Nothing herein is binding on any party.

**GAVIOS**  
REALTY GROUP, LLC